

MAKE WAY

ENVIRONMENTAL TECHNOLOGIES INC.

What is a passive wastewater treatment system and why does it matter?

In the field of wastewater treatment, "passive" is very desirable! "Passive" treatment means the process of treating or cleaning wastewater without using electrical or mechanical components. Wastewater treatment, which is essential to protect the environment and our sources of drinking water, happens naturally within the Advanced Enviro-Septic pipe. This type of wastewater treatment has many benefits.



Passive wastewater treatment is a low-cost, long-term technology since it requires:

- No energy input.
 - No costly repairs, provided that the system is operated properly.
 - Lower maintenance due to no mechanical components.
-

Passive treatment also has lower ecological impacts:

- Less sludge removal as the creation of biomass is controlled.
- No need for electricity.
 1. Lower cost to operate.
 2. Reduces cost to install as no electrician is required.
- No broken mechanical parts that must be disposed of in the landfill.
- New parts must be manufactured and transported.
- Wastewater treatment is not affected by power outages, reducing the risk of spills of untreated wastewater into the environment.

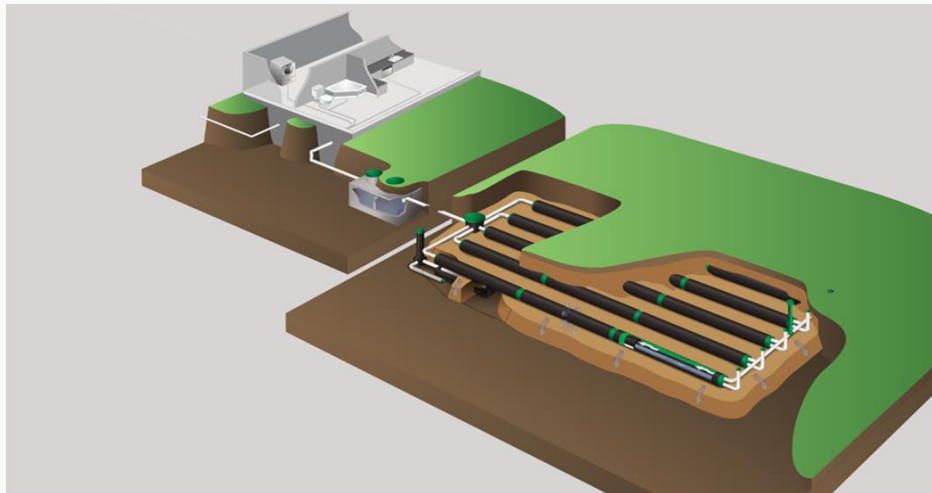

Additionally, passive treatment has a big impact on septic system sustainability:

- The main component of System O)) is the Advanced Enviro-Septic pipe. Every aspect is non-biodegradable, therefore it's relatively permanent.
- The System Sand under the piping is also relatively permanent.
- No mechanical parts that can break down and leave you with an inoperable septic system.
- System O)) will continue to work even when power surges and power outages occur.



System O))

The treatment technology forming the core of the System O)) solution is fully passive. Within the Advanced Enviro-Septic pipe, the conditions are such that the bacteria present in the sewage live and thrive as they feed on the pollutants found in domestic wastewater. The large diameter pipe allows for large volumes of air that help control the biomat. Furthermore, there is no media ever to replace, no mechanical parts to break down, and if gravity is maintained, it is a totally passive system.

This is an ideal solution for sites with difficult access for maintenance, for example an island, a remote area, or even a building without electricity, such as a cottage. Moreover, for many households it is appealing to live off grid—without using municipal sewers and electricity utilities. System O)), when properly maintained and operated should last a lifetime. By choosing passive technology, you have a septic system that is as simple as it is natural, offering you peace of mind for many years to come.

Questions? We are here!

Eastern Ontario – Roddy: 613.314.7597 rodny@makeway.ca

Central Ontario – Trevor: 519.280.4487 trevor@makeway.ca

Near North Ontario – Ryan: 705.375.2442 ryan@makeway.ca

SW and Northern Ontario – Bert: 519.709.0681 bert@makeway.ca



Questions? Call today! We are here for you!
1-866-MAKE-WAY (625-3929)

Thank you for your continued support of System O)) (Advanced Enviro-Septic System) and your recommendations to your customers. Please do not hesitate to visit our website www.makeway.ca for various documentation on the Advanced Enviro-Septic System such as our BMEC, installation manual, configurator, and Sand Tool. Also featured is our line of rainwater harvesting, stormwater management, and greywater solutions.

PROTECTING OUR ENVIRONMENT



[Add us to your address book!](#)

Copyright © 2023 Make-Way Environmental Technologies Inc, All rights reserved.

You are receiving this email to learn about new products and opportunities.

Our mailing address is:

Make-Way Environmental Technologies Inc.,

PO BOX #1869,

Exeter, ON Canada N0M 1S7